

# R-TV FINAL ANTENNA SOCKET, SEPARATED

type DAK../..

ISO 9001:2015 QMS

**KONTAKT SIMON**

43-500 Czechowice-Dziedzice

ul. Bestwińska 21

POLAND

tel. +48 32 324 63 00

fax +48 32 215 35 55

www.kontakt-simon.com.pl

e-mail: info@kontakt-simon.com.pl

Product marking:

**DAK../..**

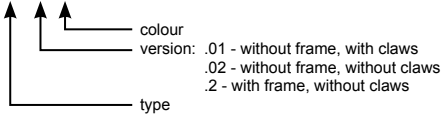

## Purpose

The antenna socket is applied in personal and community networks or cable TV systems and is used for the connection of devices such as a television set, VCR or a radio receiver to these networks.

## Application

The inputs of the socket are adapted for the connection of a coaxial cable with a  $75\Omega$  impedance, providing signal from receiving antennas. The outputs are made in line with the IEC standard allowing for the connection of a radio receiver or a TV-set. Due to a suitable structure of the outputs, the signals of the following frequency ranges are transmitted:

- **TV** output:  $5 + 70$  MHz and  $120 + 862$  MHz

- **R** output:  $88 + 108$  MHz

Coupling attenuation of **TV** and **R** outputs: 1. -1.5 dB

**DAK../..** type final antenna socket is used in community networks with star topology and in personal single-outlet systems, where the amplifier is based by the antenna while the power supply is located by the TV receiver before the antenna socket. A special structure allows for the power supply of the amplifier based by the antenna by means of an antenna cable.

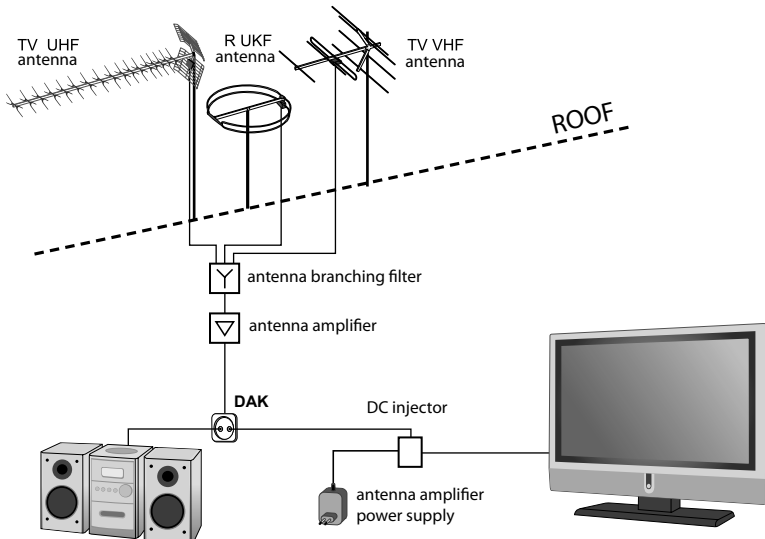
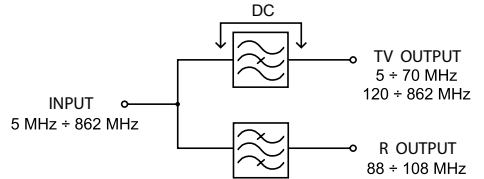
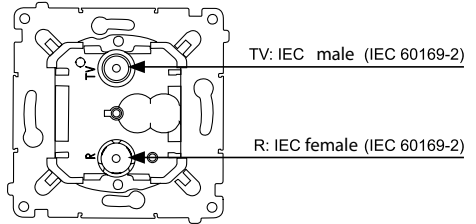

# INSTALLATION INTRUCTIONS

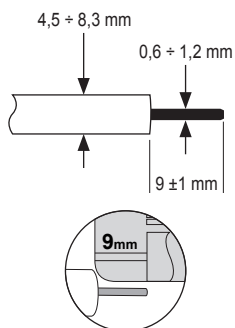

1. Prepare the ending of antenna cable for connection - strip the insulation of the coaxial cable by cutting off the external insulation, braid and internal insulation at the same length - according to marker on the housing.

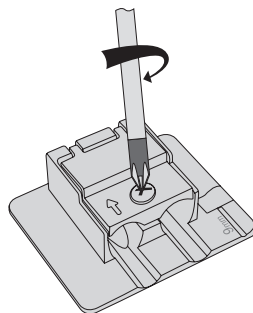

2. Lose the set screw.

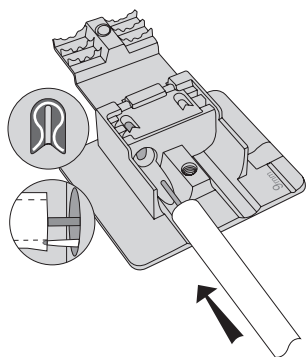

3. Insert the antenna cable to the socket clamp, paying attention for placing of blade between external insulation and braid. Check correctness of cable core placing in the terminal.

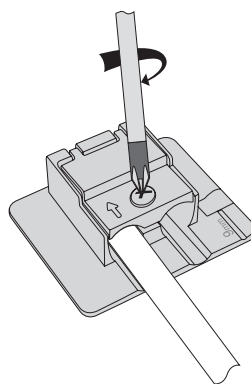

4. Tight the set screw.

5. Insert the socket to a Ø60 mm installation box and fix with clamps or fixing bolts depending on type of the box.

6. Install the frame and cover on the body of the socket body.